

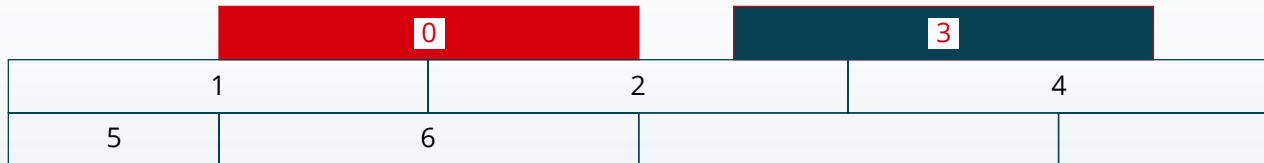

## Installing i4F Drop-Lock Technologies using alignment planks



© 2021 i4F Patents & Technologies

## Installation pattern

The installation process outlined here includes the use of 2 planks as an alignment guide (planks 0 & 3 shown above). Make sure plank 0 is centered across planks 1 and 2. Planks should be staggered in a brick laying pattern. The length of a plank must be at least 30cm/11.8 inches.

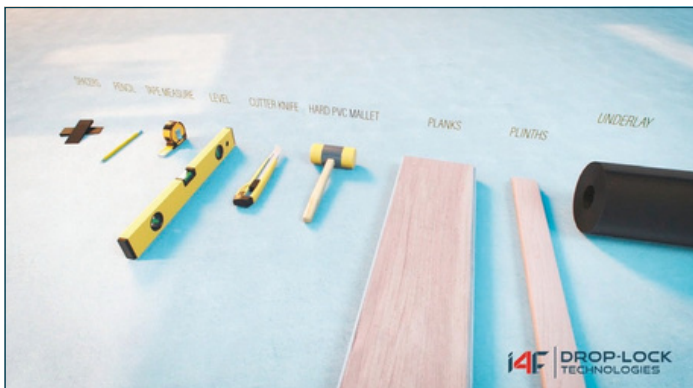

## Tools

Tools needed: spacers, pencil, tape measure, level, cutter knife, hard PVC mallet.

Optional: Plinths.

## Preparation

- Acclimatize your floor panels for 48 hours prior to installation at a room temperature between 18 to 25 °C, that is 64 to 77 °F.
- Ensure your subfloor is clean, level, and stable. Maximum allowed height difference is 5mm/0.2" over a distance of 2m/6.6 feet.
- Check for any peaks or depressions in your subfloor as these will need to be addressed.
- Remove any last obstructions such as glue, nails or screws.
- Check the floor panels for any damages.



## Align installation

It is very important that the first 2 rows are aligned. Use a full plank (0) as an alignment guide and place it against the wall. No need for spacers yet.



## Install plank 1

Next, take another full length plank, angle it into the middle of the long side of plank 0 and drop. Ensure there are no gaps.



## Install plank 2

Take another full length plank and angle it into plank 0. Then slide plank 2 until the short side makes contact with the short side of plank 1.



## Engage the short sides

Drop the short side of plank 2 onto the short side of plank 1. Drop & Lock by pushing down firmly. If necessary, use a hard PVC mallet to tap the joints slightly on the short side. This ensures 3-fold locking.

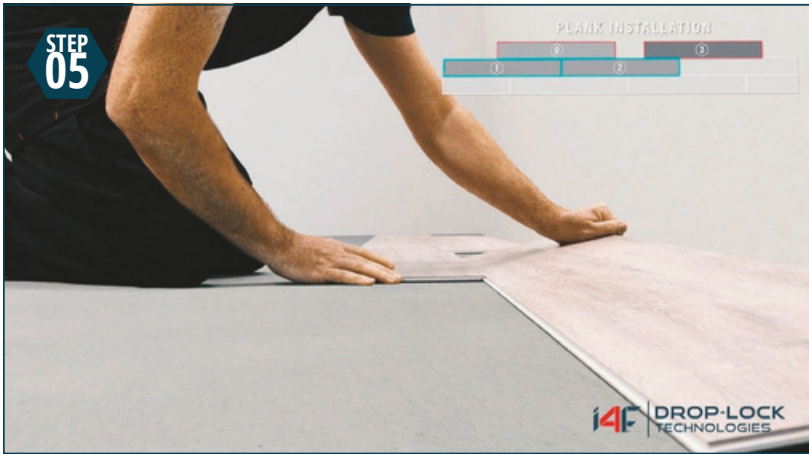

## Align installation

Use a full plank (3) as an alignment guide by placing it against the wall. Angle plank 3 into plank 2.



## Install plank 4

Take another full length plank and angle it into plank 3. Then slide plank 4 until the short side makes contact with the short side of plank 2. Drop & Lock by pushing the planks firmly down, if necessary use a hard PVC mallet to tap the joints slightly on the short side to secure it. Ensure there are no gaps or height differences.



## Finish rows 1 and 2

Start your second row by using half a plank (5) and angle in with plank 1. Make sure the short sides are aligned. Repeat the same steps as above to finish the second row. Ensure there are no gaps or height differences.

## STEP 08: Remove alignment planks (planks 0 & 3)

Remove planks 0 and 3 by angling them out.



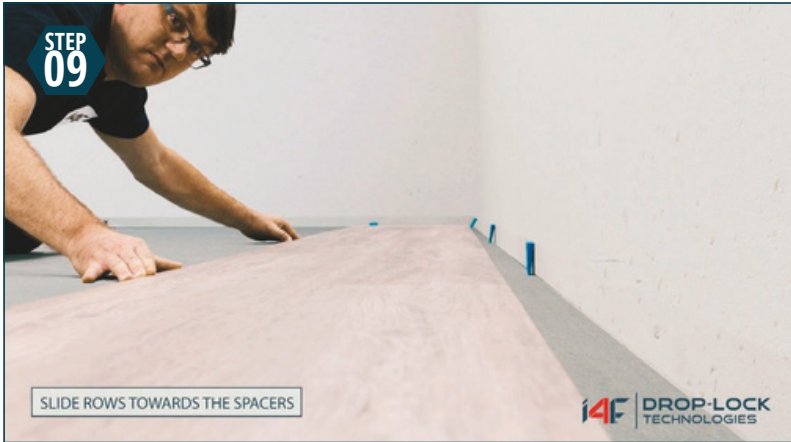

## Use spacers & slide rows towards spacers

Place the spacers along the walls to create an expansion space of 5mm/0.2 inches. Proceed by gently sliding rows 1 and 2 towards the spacers.



## Finalize installation

From row 3 onwards, installation does not require a specific laying pattern. To finish the last row, measure the distance from the wall to the last installed row minus 5mm/0.2 inches. Remove spacers when installation is complete. Finish up the room by placing any plinths, molding and trim.



## Disassembling the long side

Lift up the entire row with the same angle as you did during installation, then slide the rows apart.

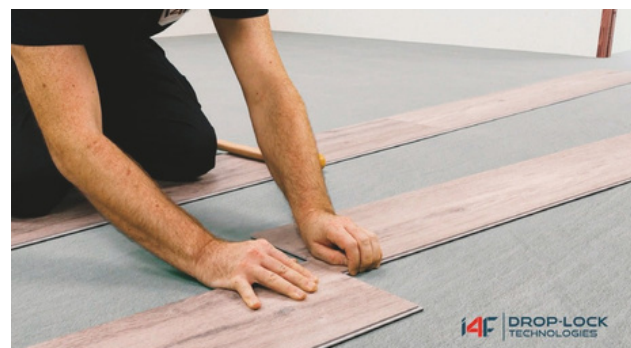

## Disassembling the short side

Disassemble the row by sliding apart the planks on the short side. Ensure the planks are laying completely flat. If you cannot slide the panels apart, the short side is not fully engaged. Tap with the mallet to engage then slide out.

## **PLEASE READ BEFORE STARTING:**

Check your SPC click flooring for possible defects prior to the installation. Complaints can only be accepted before installation. Slight variations in colour and structure are designed to enhance natural appearance. Mixing the sheets creates a uniform laying pattern. SPC click flooring is production-run sensitive. Ensure that all planks you are installing come from the same production run. Proper Floors® cannot guarantee that any future replacement or additional installation will match the originally installed product.

SPC Click is a floating floor suitable for indoor installations only, in a controlled environment (while occupied) within the required temperature range of 55° F to 100°F (12.78°C to 38°C). Do not install outdoors.

### **SUITABLE SURFACES**

Lightly textured or porous surfaces; well-bonded solid floors; dry, clean well-cured concrete (cured for at least 60 days prior); wood floors with plywood on top. All surfaces must be clean and dust free. The floor can be installed over radiant heated floors (do not turn heat above 29° C or 85 F). The heating system needs to be operational and working for one week prior to the install date to reduce any residual moisture. Should the Radiant heating system be in use at the time of installation it is necessary to lower the temperature to 65°F (18.3°C) for a minimum of three days prior to the installation date, during the entire installation, and for 24 hours following upon completion of the installation. The temperature can then be gradually increased in 5° increments. Temperature must never exceed 85°F (29°C).

### **UNSUITABLE SURFACES**

Rough, uneven surfaces including carpet and soft underlay. Rough, heavy textured and/or uneven surfaces may telegraph through the vinyl and distort the finished surface. This product is not suitable in rooms that could potentially flood or rooms that have damp concrete or saunas. Although your flooring does have a UV layer, do not install this product in areas which are exposed to long term direct sunlight such as sunrooms or solariums. Do not install over rubber- based substrates.

**Do not install fixed objects, such as cabinets, islands, wall units etc. on top of the flooring or fasten trim/molding/transition pieces directly to the floor.**

Your SPC Luxury Vinyl Flooring is waterproof but is not a moisture barrier. Water traveling over or around the outer edges of the flooring can damage the subfloor. Water damage and or associated conditions are not warranted. In addition, other contaminants could migrate up as well. These are not manufacturing related conditions.

When installing in a lavatory, bathroom, laundry room, or other area with frequent water usage, it is recommended that any perimeter gap be filled with a silicone caulk. This will lower the possibility of the water traveling under the floating floor and help to reduce bacterial growth and problems associated with it.

## **CARE AND MAINTENANCE**

Sweep regularly to remove surface grit and dust. For everyday cleaning, use a vacuum cleaner with wand attachment, a sweeping broom, or a slightly dampened mop but avoid using excessive moisture. All spills should be cleaned up immediately.

Never use wax, polish, abrasive cleaners or scouring agents as they may dull or distort the finish. Do not buff your floors. High heels can damage floors. Use protective pads under furniture. Hard surface mats are required under office chairs. Use doormats at entrance ways to protect the floor from discolouring, tracked-in dirt, sand, and pebbles. Heavy furniture and appliances should be equipped with non-staining large surface floor protectors. Do not allow pets with unclipped nails to scratch or damage the floor.

Care must be required whenever furniture is moved, furnished should never be dragged across the floor. Use appropriate moving pads if necessary.

**Never steam clean or use a steam mop on the floor.**

Avoid exposure to direct sunlight for prolonged periods of time. Use drapes or blinds to minimize direct sunlight during peak sunlight hours.

It's a good idea to save a few planks in case of accidental damage. Planks can be replaced or repaired by a flooring professional.

[www.ProperFloors.ca](http://www.ProperFloors.ca)